

INDEX NO.	PART NO.	DESCRIPTION	QUANTITY
1	A100	Housing, Complete with Bushings	1
	SA11	Screw, for all Bushings	8
	A121	Oiler	5
2	A119	Cover, Top	1
	SA27	Screw, Attaching, for A119	2
3	A108	Cover, Side Nameplate Screw,	1
	SA20	Attaching, for A105	4
4	A513	Lock Ring	4
5	A512	Bearing, Cone	2
6	A214	Stud, Feed Dog Carrier Slide	1
	SA20	Screw, Attaching, for A214	2
7	A102	Cover, Looper	1
	SA20	Screw, Attaching, for A102	1
8	A21	Throat Plate	1
	SA34	Screw, Attaching for Guide Plate	2
	SA27	Screw, Attaching for A210	3
9	A101R	Guard, Needle Bar	1
	SA21	Screw, Attaching, for A101R	1
12	A400	Presser Foot, Complete	1
	SA04	Screw, set, for A400	1
	SA14	Bolt, Hinging, for A400	1
	A711	Nut, for SA14	1
13	A413	Bushing, Presser Bar, Lower	1
14	A414	Spring, Presser Bar	1
15	A405R	Clamp, Presser Bar	1
	SA38	Screw, Clamping, for A405R	1
16	A404	Presser Bar	1
17	A412	Bushing, Presser Bar, Upper	1
18	A407R	Lifter Guide	1
	SA32	Screw, Attaching, for A407P	2
22	D5	Needle	1
23	A501	Locknut, Needle	1
24	A504	Bushing, Needle Bar, Lower	1
25	A502	Clamp, Needle Bar Complete	1
	SA26	Screw, Clamping, for A502	1
26	A500	Needle Bar	1
27	A508	Bushing, Needle Bar, Upper	1
28	A505	Lever, Needle Bar	1
	SA10	Screw, for A505	2
29	A511	Stud, Needle Bar Lever	1
32	A507	Stud Connecting Rod End	1
33	A510	Spring	1
34	A208	Washer, for SA13	1
35	SA13	Nut, for A607R	1
37	A116	Nut, Tension	1
40	A115R	Spring, Tension	1
41	A114	Disc, Tension	2
42	A113	Stud, Tension	1
43	A109R	Thread Guide	1
46	A607R	Bearing, Rod End	1
47	A608R	Locknut, for D607	1
49	A605	Collar, Retaining for A600	1
	SA03	Screw Clamping, for A605	1
50	A606	Connecting Rod and Eccentric, Complete	1
	SA02	Screw, Cone Point, for A606	1
	SA09	Screw, Set for A605	1
51	A602	Bushing, Main Shaft, Front	1
52	A600	Main Shaft	1
53	A601	Bushing, Main Shaft, Rear	1
54	A310	Cam, Looper, Complete	1
	SA24	Screw, Cone Point, for A310	1
	SA23	Screw, Set, for A310	1
55	A308	Stud, Cam Follower	1
	A309	Locknut, for D308	1
56	A307	Arm, Cam Follower	1
	SA26	Screw, for A307	1
57	A304	Collar, Looper Shaft	1
	SA25	Screw, Clamping, for A304	1
58	A303R	Shaft, Looper	1
59	A306	Bushing, for A303R	1
60	A301R	Holder, Looper	1
	SA29	Screw, Looper Set	1
	SA19	Screw, Clamping, for A301R	1
61	A300	Looper	1
62	A200	Feed Dog Carrier Block and Slide	1
63	SA30	Screw, Feed Dog Adjusting	4
	SA15	Screw, for A205	2
64	A208	Washer, for SA13	2
65	A205	Slide Block, Adjusting	1
66	A206	Stud, Slide, Block Adjusting Support	2
	A209	Locknut, for A206	2
67	A203	Feed Dog	1
68	SA22	Screw, Attaching for A203	1
69	SA13	Screw, knife Bracket	1
70	A714	Lockwasher, for SA13	1
71	N001	Locknut	1
72	A700	Bracket, Knife	1
73	A704	Spring, Knife Tension	1
74	A707	Shaft	1
75	A708	Bushing, for A707	1
	A702	Knife, Moving	1
	SA08	Screw, Attaching, for A702	2
76	A705	Knife, Stationary	1
	SA07	Screw, Attaching, for A705	2
79	A709R	Roller	1
80	SA15	Bolt, for A709	1
81	A712	Extension, Knife Bracket Support	1
	SA12	Screw, Attaching, for A712	2
83	A105	Guard, Belt	1
	SA09	Screw, Attaching, for 105	4
84	A909	Belt	1
85	A904	Pulley, Machine	1
86	A802	Cover, Switch	1
	SA27	Screw, Attaching, for A802	2
87	A807	Insulation	1
88	A806	Switch	1
	A814	Screw, Switch Terminal	5
89	A800	Handle, Complete, with Cover	1
	SA18	Screw, Attaching, for A800	2
90	A808	Cord Set	1
91	A809	Clamp, for A808	2
	SA11	Screw, Attaching, for A809	1
92	A913-2	BX Motor Leg	1
	SA11	Screw, Attaching for A913-2	1
93	A804	Bolt, Thread Clamping	1
94	A805	Nut	1
95	A815	Thread Stand	1
	SA17	Screw, Attaching, for A815	2
96	A901	Motor Set	1
	SA21	Screw, for A901	4
97	A902	Pulley, Motor	2
	SA29	Screw, for A902	1
98	A900	Motor	1
	SA16	Screw, for motor	2
99	A915R	Brush	2
100	A917R	Screw, Brush-Holder Cap	2

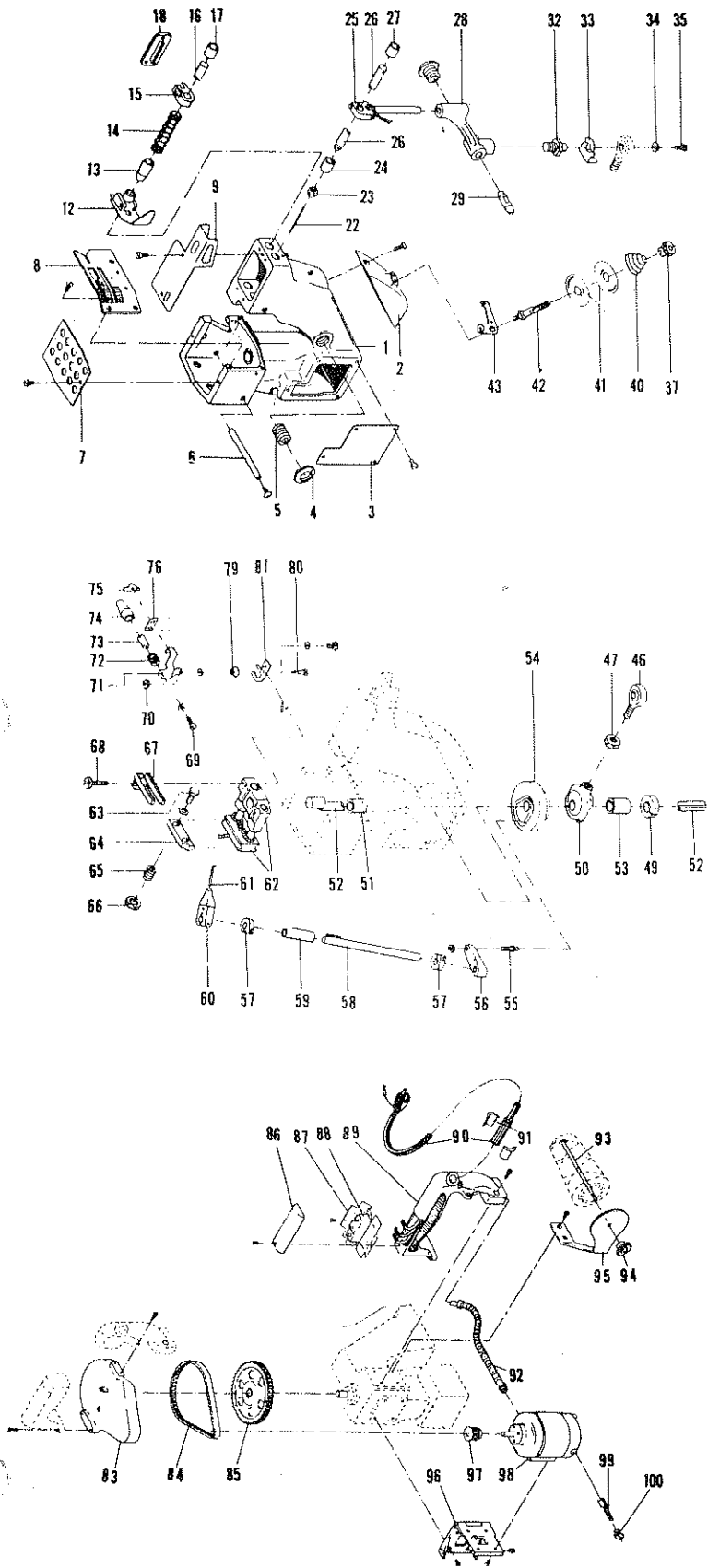

From the library of: Diamond Needle Corp